

Always observe for safety and securely install the optional parts

Note: Wind Deflectors are needed for operation where the ambient temperatures fall below -5° C.

Installer/Maintenance: When ordering optional parts use the Stamping # or Model Name as shown below

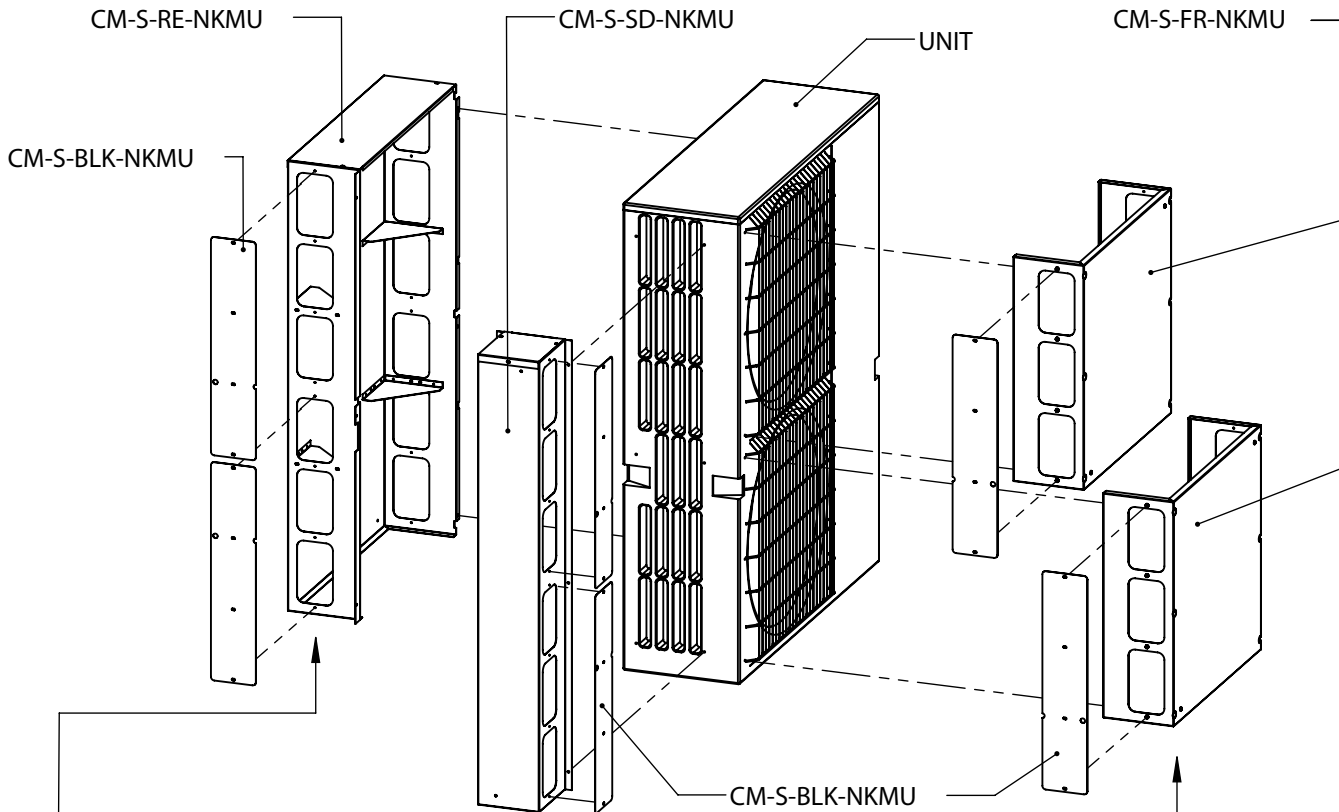

CM-S-RE-NKMU
Stamping # 022

- Without removing the grille, align rear panel with existing screw holes in the unit and secure with 6 pcs #10 screws provided with the panel.
- Rear panel is provided with 2 pcs wind blocker panels already installed on one side of the panel. Move or remove as required.
- Ensure safety cables attached to the panel are secured to the unit properly

CM-S-SD-NKMU
Stamping # 023

- Align side panel with existing screw holes in the unit and secure with 6 pcs #10 screws provided with the panel.
- Side panel is provided with 2 pcs wind blocker panels already installed on one side of the panel. Move or remove as required.
- Ensure safety cables attached to the panel are secured to the unit properly

CM-S-FR-NKMU
Stamping # 025

- Without removing the grille, align front panel with existing screw holes in the unit and secure with 6 pcs #10 screws provided with the panel.
- Wind blockers are not provided for the front panels. If required they have to be ordered separately.
- Ensure safety cables attached to the panel are secured to the unit properly

Wind Deflector
CM-S-BLK-NKMU Stamping # 024
is universal fit for all panels

Warning: Do not drill into the unit cover as damage can occur to the heat exchanger coil causing refrigerant leaks. Use existing holes for installing purposes.