

Submittal Data: s-MEXT-G02-M1 DX (O/U)* 013 S F1

42,000 BTU/H Indoor Evaporating Unit for IT Cooling Application

*O = Over (Upflow); U = Under (Downflow)

Job Name:	Location:
Schedule Reference:	Submitted By:
Submitted To:	For: Reference Approval Construction
Engineer:	Date: Application:

 <p>s-MEXT + PUY Split-DX CRAC System</p> <ul style="list-style-type: none"> For small-mid size data room Applications Available with Dehumidification and Humidification features for precision Temperature and Humidity Control Available in Upflow (Over version) or Downflow (Under Version) Total front Service accessibility LAN connection of up to 10 units Designed for operation with PUY outdoor condensing units Wide Variety of Options & Accessories to suit every application <p style="font-size: small;">Images for reference purposes only</p>	Standard Configurations: MESCA Part No.	Description
	s-MEXT-0130-3000 (Upflow) s-MEXT-013U-3000 (Downflow)	s-MEXT-G02-M1 DX O/U 013S; Includes all standard features + Smoke Detector, Fire Detector and Basic Function(s)
	s-MEXT-0130-3110 (Upflow) s-MEXT-013U-3110 (Downflow)	s-MEXT-G02-M1 DX O/U 013S; Includes all standard features + Smoke Detector, Fire Detector and Electric Reheat Function(s)
	s-MEXT-0130-3210 (Upflow) s-MEXT-013U-3210 (Downflow)	s-MEXT-G02-M1 DX 013S; Includes all Standard features + Smoke Detector, Fire Detector and Steam Humidifier Function(s)
	s-MEXT-0130-3310 (Upflow) s-MEXT-013U-3310 (Downflow)	s-MEXT-G02-M1 DX O/U 013S; Includes all Standard features + Smoke Detector, Fire Detector and Electric Reheat + Steam Humidifier Function(s)
	Custom Config. (Select Size and Version)	Description
s-MEXT-G02-M1 DX F01 O 013 S (Upflow)	s-MEXT-G02-M1 DX Custom Built-to-Order Unit (Check required size and version, in addition to required options on Page 2-3).	
s-MEXT-G02-M1 DX F01 U 013 S (Downflow)		

Rated Capacity: (Cooling capacity indicated at the maximum value at operation under the following conditions Note: ¹)

Cooling ¹	Btu/h	40,263
Matched Outdoor Unit ⁶	Model	PUY-A42NKA7

s-MEXT Indoor Unit Specifications:

Power Supply (Basic Unit, See below for Electrical ratings when other options/features are selected)		208/230V, 1Ph, 60Hz
Minimum Circuit Ampacity MCA ² (Basic Unit)	A	4.1 (Cooling only)
Maximum Fuse/Breaker Size (Basic Unit)	A	15
Fan Type x Quantity		Backward curved centrifugal fan x 1
Motor Type x Quantity		DC motor x 1
Airflow Rate	CFM (m ³ /h)	1534 (2606)
Sensible Heat Ratio (SHR)		0.88
External Static Pressure	In. WG (Pa) [Upflow/Downflow]	1.43(355) / 1.49(371)
Sound (Pressure Level / Power Level) [ISO EN 3744]	dB(A)	(61 / 77)
Drain Pipe Size	In. (mm)	FPT 3/4 (19.02)
External Finish		Galvanized steel cabinet - Painted with epoxy powder (RAL7016)
Coil Type		Cross Fin (Aluminium Plate Fin and Copper Tube)
Air Filter		MERV8 Washable - Synthetic fibre
Unit Dimensions	W: In. (mm)	23-5/8 (600)
	D: In. (mm)	19-11/16 (500)
	H: In. (mm)	77-15/16 (1980)
Net Weight	Lbs. (kg)	242.5 (110)
Refrigerant Pipe Diameter (gas) (Braze)	In. (mm)	5/8 (15.875)
Refrigerant Pipe Diameter (liquid) (Braze)	In. (mm)	3/8 (9.525)

Standard Features		Indoor Unit Electrical Ratings (Units with optional accessories/features installed)	
Option No.	Description		
A724	Basic EC Fan	Cooling + Electric Reheat	Minimum Circuit Ampacity (MCA) ²
6192	Compact Keyboard		Maximum Fuse/Breaker Size
A501	Clogged Filter Sensor	Cooling + Steam Humidifier	Minimum Circuit Ampacity (MCA) ²
A491	Water Leakage Detector		Maximum Fuse/Breaker Size
P662	MERV 8 Air Filter	Cooling + Electric Reheat + Steam Humidifier	Minimum Circuit Ampacity (MCA) ²
			Maximum Fuse/Breaker Size

PUY Outdoor Unit Specifications:	s-MEXT + PUY System Specifications
----------------------------------	------------------------------------

Electrical Power Requirements	V/Ph/Hz	208/230 V, 1-Ph, 60 Hz	Rated Capacity - Total BTU/h (kW)	40,263 (11.7)
Minimum Circuit Ampacity MCA ²	A	25	Rated Capacity - Sensible BTU/h (kW)	34,121 (10.3)
Breaker Size / MOCP	A	30 / 31	Sensible Heat Ratio (SHR)	0.88
Compressor		DC Inverter-driven Scroll	System EER (nominal) BTU/hW (W/W)	10.87 (3.19)
Fan Motor (ECM) FLA	A	0.5 + 0.5	Rating Conditions	Indoor Cooling: 80.6°F (27°C) DB - R.H. 47%; ESP = 0.08 in. w.c. (20 Pa)
Fan Motor Power (Watts)	W	74		Outdoor Conditions: 95°F (35°C) DB / 75°F (24°C) WB
Airflow Rate, Dry	CFM (m ³ /h)	3880 (6592)	Operating Range*	5 °F (-15 °C) to 115 °F (46 °C) DB
Sound Pressure Level	dB(A)	52		

PUY ODU Options		
	Outdoor Unit Model	Standard Model
Net Weight	Lbs. (kg)	211 (96)
External Finish		Munsell No. 3Y 7.8 / 1.1
Refrigerant	Lbs. (kg)	R410A ; 10 lbs, 6 oz. (4.7 kg)
Refrigerant Piping (Flared)	In. (mm)	Liquid: 3/8" (9.52) ; Gas: 5/8"
Maximum Total Ref. Pipe Length	Ft. (m)	225 (69)
Maximum Vertical Separation	Ft. (m)	100 (30)
		Outdoor Unit Model
		Standard Model
		Seacoast (BS) Model
		PUY-A42NHA7
		Rear Snow Guard
		SG-1-RE
		Side Snow Guard
		SG-1-SD
		Front Wind Deflector
		CM-S-FR-NKMU (x2 Required)
		Front Wind Blocker
		CM-S-BLK-NKMU (x2 Required)
		*Wind Guards Are Required Below 23 °F (-5 °C) Ambient

Optional Accessories

Option Code	Description
FAN PRESSURE CONTROL TYPE	
A724 [STD]	Basic EC Fan
A548	Constant Air Pressure: automatic system for the air pressure control in the underfloor (downflow) or in the (upflow)
A547	Constant Air Flow: automatic system for the air flow control in the underfloor (downflow) or in the duct (upflow)
USER INTERFACE	
1441	Control of unit via KIPLINK + Compact Keyboard
1442	Control of unit via KIPLINK + 7 Inch Touchscreen (Replaces Std. Compact Keyboard)
6192 [STD]	Compact Keyboard
6196	Control Unit via KIPLINK (Removes Std. Compact Keyboard)
6195	Compact 7 Inch Touch Screen (Replaces Std. Compact Keyboard)
C9261063	Additional Remote Compact Display (Supplied in field kit)
LOWERED DISPLAY (UNDER/DOWNFLOW VERSION ONLY)	
P151	Lowered display for under/downflow version: for units equipped with plenum under the unit
FREECOOLING MANAGEMENT (UNDER/DOWNFLOW VERSION ONLY)	
A812(1)	Free-cooling direct control
ELECTRIC HEATER & DEHUMIDIFICATION FUNCTION	
A431	Basic Electric Heater (2-Stage, 2.6 kW Total Capacity)
P051	Dehumidification Function (Requires Opt. A431)
STEAM HUMIDIFIER	
4301	Steam Humidifier 3 kg/h UM03
TEMPERATURE/HUMIDITY SENSOR(S)	
P161 [STD]	T/RH Sensor mounted in unit Return Air Section
P071	Remote Sensor T/RH (1 Probe)
P072	Remote Sensor T/RH (2 Probe)
P073	Remote Sensor T/RH (3 Probe)
P074	Remote Sensor T/RH (4 Probe)
4666	External Air Temperature Sensor
SERIAL CARD FOR BMS	
A471	RS485 Serial Card
A473	Ethernet Serial Card
A474	LON Card
A477	BACNET over IP Serial Card
FIRE/SMOKE DETECTOR & WATER LEAK DETECTOR	
A521	With Fire Detector (Supplied in mounting kit for field installation)
A511	With Smoke Detector (Supplied in mounting kit for field installation)
A492	Additional Water Leak Detector (Supplied in mounting kit for field installation)
INSULATION & FILTRATION	
A272	Class 0 (A1 DIN 4102) Cabinet Insulation
P663	MERV 11 Air Filter
AIR TEMPERATURE CONTROL	
A791	Return Air Control
A792 [STD]	Delivery Air Control

Optional Accessories

Option Code	Description
MISCELLANEOUS ELECTRICAL OPTIONS & ACCESSORIES	
P091	Back-up module controller. The system guarantees the microprocessor power supply for a few minutes, in case of supply voltage failure during ATS switching. Not compatible with "Free-cooling plenum" and "Steam humidifier" optional accessories.
P113	Automatic Transfer Switch (ATS) Kit for both Indoor and Outdoor Unit for Dual power supply for emergency operation
A842	Network analyser: Multifunction utility for calculating and displaying the machine electrical measurements
SHEET METAL OPTIONS & ACCESSORIES	
P101	Anti-seismic fixing kit; supplied in mounting kit
A532	Damper with spring return: non-return air damper driven by electric servomotor installed on the top of units on all versions
P011	Empty Supply Air Plenum
P012	Empty Supply Air Plenum with Insulation
P013 / P014	Supply Plenum + 3 grilles. Plenum with grilles on three sides with double adjustable row
P015	Silenced Supply Air plenum
P016	Silenced Supply Air Plenum + 1 grille. Plenum with grille with double adjustable row on front with sound absorbers
P031	Empty intake plenum (Under/Downflow Version Only)
P032	Empty intake plenum with insulation (Under/Downflow Version Only)
P033	Silenced intake plenum (Under/Downflow Version Only)
P034(4)	Intake free-cooling plenum for Under/Downflow version Only (includes Damper control). Requires the Opt. P161 (Return Air mounted T/RH Sensor) and Opt. 4666 (Ambient Air Temperature Sensor) and Opt. A812 (Free-Cooling Direct Control).
P041	Support Frame H = 255-350 mm (10-14 inches) Adjustable
P042	Support Frame H = 355-450 mm (14-18 inches) Adjustable
P043	Support Frame H = 400-510 mm (16-20 inches) Adjustable
Please refer to Databook for sheet metal accessories, combinations and details.	

Notes:

Notes:

MANDATORY COMBINATIONS OF ACCESSORIES

- 1) When optional accessory "A813 Free cooling direct control" is present, it requires mandatory accessories "P161 T/rH air intake sensor" and "4666 External air probe"
- 2) When optional accessories "4301 / 4303 Steam humidifier" are present, they require mandatory accessory "P161 T/rH air intake sensor"
- 3) When optional accessory "P051 Dehumidification function" is present, it requires mandatory accessory "P161 T/rH air intake sensor"
- 4) When optional accessory "P034 Intake free-cooling plenum" is present, it requires mandatory accessories "P161 t/rH air intake sensor", "4666 External air probe", "A812 Free-cooling direct control"

Notes & Specifications:

1. Cooling (Indoor// Outdoor): 80.6 °F (27 °C); 47% RH // 95 °F (35 °C); Indoor Unit ESP: 0.08 In.WC (20 Pa), Connection pipes length = 16.4 ft. (5 meters)
2. All electrical work shall comply with National (CEC) and local codes and regulations.
3. Applications should be restricted to **small and medium IT room applications only**; comfort heating and cooling applications are not recommended.
4. Mitsubishi Electric Sales Canada Inc. (MESCA) supports the use of only MESCA supplied and approved components and accessories for proper functioning of the unit(s). **Always consult relevant technical product documentation at mitsubishitechinfo.ca, your local distributor or MESCA BC sales office as applicable.** Use of non - MESCA supported components and accessories will affect warranty coverage. MESCA recommends (A) consideration of all applicable design and application parameters and requirements specific to any project; and (B) implementation of any countermeasures needed to address those parameters and requirements, including the provision of antifreeze solution in water based systems used in conjunction with ducted indoor units.
5. All components of the system must be compatible.
6. Wind Guards are **Mandatory** for the Outdoor Condenser when Outdoor Design/Operating Temperature is 23 °F (-5 °C) or below.
7. **s-MEXT Series Indoor Units are compatible with PUY Cooling-only Outdoor Units for operation down to -15 °C Outdoor Ambient Temperature.**
8. Should any person change this document in any manner whatsoever without MESCA's written permission, the document shall be of no force and effect and any change shall be deemed to be a representation and warranty made by that person and not MESCA. That person, and not MESCA, shall assume full responsibility for the consequences of such changes. MESCA assumes no responsibility for any consequences in such cases.

Indoor Unit Outline and Dimensions:

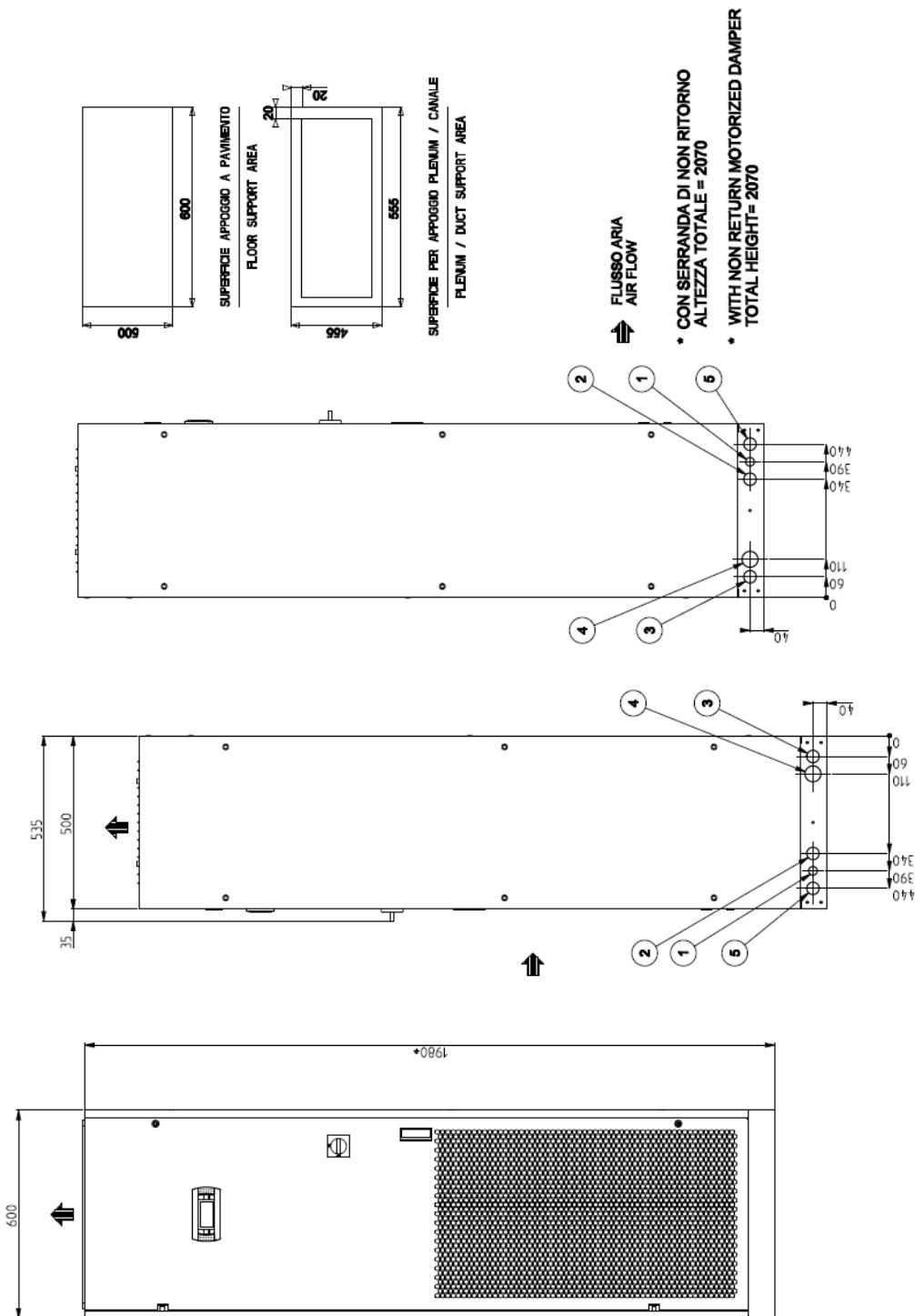

FLUSSO ARIA
AIR FLOW

* CON SERRANDA DI NON RITORNO
ALTEZZA TOTALE = 2070

* WITH NON RETURN MOTORIZED DAMPER
TOTAL HEIGHT = 2070

CONNESSIONI / CONNECTIONS	
5	ALIMENTAZIONE ELETTRICA POWER SUPPLY
4	CARICO ACQUA UMIDIFICATORE Ø 3/4" HUMIDIFIER FILL G 3/4"
3	SCARICO ACQUA UMIDIFICATORE Ø 19mm. CONDENSATE DISCHARGE Ø 19mm.
2	ATTACCO GAS Ø 8/8" ODS GAS CONNECTION Ø 8/8" ODS
1	ATTACCO LIQUIDO Ø 3/8" ODS LIQUID CONNECTION Ø 3/8" ODS
3	/
2	/
1	/

INTELL.	MODIFICAZIONE	APPROVATO	REV.	DATE
1			1	28.10.19

-TOLERANZE ACCORDING TO ISO 2768 -SPAZZI METALLICI ACCORDING TO ISO 14553 -PLASTICI ACCORDING TO ISO 14553	MITSUBISHI ELECTRIC The parts are required for the assembly of the indoor unit. For IS drawings	For IS: The parts are required for the assembly of the indoor unit. For IS drawings	SCALE: - UNIT: - DRAWING NO.: D51.80655002 - 0 REV. A2
--	--	---	---

PROJECT	SPLIT SYSTEM AIR CONDITIONERS FOR IT COOLING
INDOOR UNIT	S-MEXT-G02-M1 DX O 006-013 S F1

CONFIDENTIAL DOCUMENT. PROPERTY OF MITSUBISHI ELECTRIC CORPORATION. ALL RIGHTS RESERVED. NOT BE REPRODUCED NOR RELEASED WITHOUT COMPANY MITSUBISHI COMPANY.

Indoor Unit Outline and Dimensions:

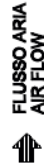
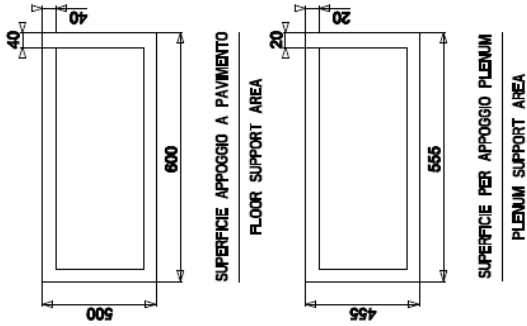

- * CON SERRANDA DI NON RITORNO ALTEZZA TOTALE = 2070
- * WITH NON RETURN MOTORIZED DAMPER TOTAL HEIGHT= 2070

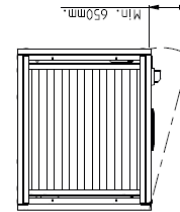
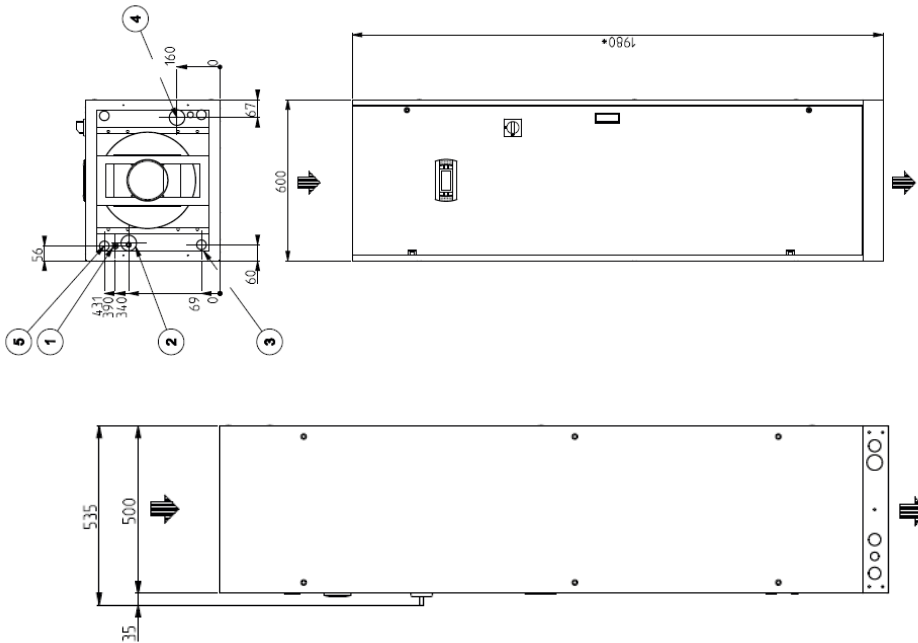
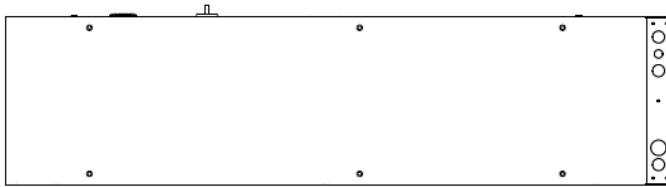

CONNESSIONI / CONNECTIONS	
5	ALIMENTAZIONE ELETTRICA POWER SUPPLY
4	CARICO ACQUA UMIDIFICATORE Ø 3/4" HUMIDIFIER FILL Ø 3/4"
	SCARICO ACQUA UMIDIFICATORE Ø 19mm. HUMIDIFIER DRAIN Ø 19mm.
3	SCARICO CONDENSA Ø 19mm. CONDENSATE DISCHARGE Ø 19mm.
2	ATTACCO GAS Ø 5/8" ODS GAS CONNECTION Ø 5/8" ODS
1	ATTACCO LIQUIDO Ø 3/8" ODS LIQUID CONNECTION Ø 3/8" ODS
3	
2	
1	

REVISIONI / MODIFICAZIONI	REVISIONS / MODIFICATIONS	DATE	BY	APP. / SIGNATURE	SCALE	SHEET NO.	TOTAL SHEETS
1		29.10.19	D.A.			1	A2

REQUISITI:
The parts are required to meet the latest ASHRAE standards.

PRODOTTORE:
MITSUBISHI ELECTRIC

MODELLO:
SPLIT-SYSTEM AIR CONDITIONERS FOR IT COOLING

INDOOR UNIT
S-MEXT-G02-M1 DX U 006-013 S F1

IDENTIFICAZIONE UNITARI: D6L8055001_0

Outdoor Unit Outline and Dimensions:

Unit: mm (in.)

